

Mineral Deposits – Grande Côte



Client: Mineral Deposits Limited
Location: Republic of Senegal
Commencement: 2011

Capability Groups: Mineral Processing
Completion: 2014

Services Provided

- Metallurgical testing
- Flowsheet development
- WCP engineering design
- Process equipment supply
- Process equipment commissioning
- Operator training
- Design and supply field pump units

Highlights

- Design of the world's largest floating wet concentrator plant for mineral sands
- Supply of gravity, magnetic and surge bin technology
- Metallurgical testing over 3-year period

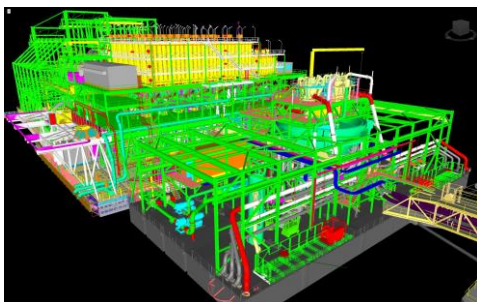

Smart Engineering

Mining began at the Grande Côte project in Senegal in 2014. This marked the 13th year of Mineral Technologies' long association with the project.

Starting in 2001, Mineral Technologies conducted the first metallurgical testing of 100 tonne bulk samples. Over the years this expanded into further testing resulting in the development of process flowsheets to deliver optimum separation of Zircon and Ilmenite.

Given proven expertise in fine separation and considered metallurgical knowledge of the ore body, Mineral Deposits engaged Mineral Technologies to design the WCP which would become the world's largest Mineral Sands Spiral Plant. In addition, Mineral Technologies was engaged to design specific process equipment including a 7,000tph Surge Bin and Tails Densification Modules.

Latest Technology

The WCP design incorporated state-of-the-art high capacity spiral technology sourced from Mineral Technologies proprietary equipment range. It also included a purpose designed Feed Surge Bin and Tails Densifying Bin to meet specific process needs.

Today the Grande Côte project is a leading example of excellence in Mineral Sand separation and through smart design and innovative technology is expected to continue through the anticipated 20 year life of the mine.

